

Drawing Floor Plans

Even though buildings are 3-D spaces, architects use 2-D drawings to create their designs and organize their ideas. A *floor plan* is a 2-D drawing of a building or room from an overhead view. It is like a map of the space. Sketch a floor plan of a room in your home using the plan drawing symbols below. Here is a [quick overview](#) and a [video demonstration](#) of the process to help you get started.

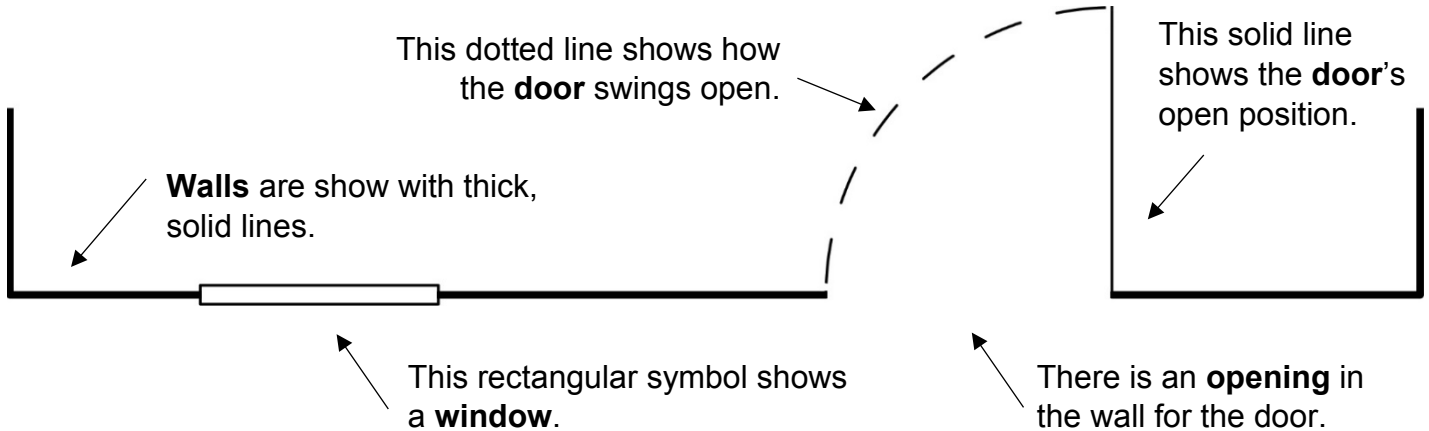

Materials

Pencil • Ruler • Paper • Eraser

Instructions

	<p>Step 1 Pick a room in your home and figure out the overall shape. Is it a rectangle? A square? A trapezoid? Lightly draw this shape on your paper to show the walls.</p>
	<p>Step 2 Look at each wall to observe where there are openings for windows, doors, and walkways. Mark these openings on your sketch and erase those portions of the wall outline.</p>
	<p>Step 3 Use the symbols above to draw in the doors and windows. Thicken your outline for the walls to show they are solid.</p>
	<p>Step 4 You can add furniture to your sketch by drawing their shapes as seen from above. Make sure your plan drawing works like a map, so it shows their correct locations in the room.</p>
	<p>Step 5 Share a photograph of your creation on Instagram! Tag @centerforarchk12 and use #architectureathome.</p>